



POWER RAIL™

Top-Clamping PV Mounting System Catalog P6 and P8 Rails



-  COMMUNICATIONS
-  ENERGY
-  SPECIAL INDUSTRIES
-  SOLAR

Quality Hardware for the PV Industry



POWER RAIL™ Module Mounting System

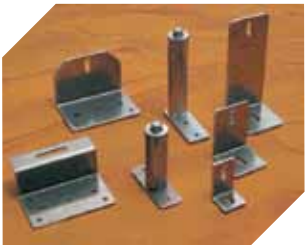

Top-clamping PV module mounting system engineered to reduce installation costs and provide maximum strength for parallel-to-roof or tilt up mounting applications.

The Power Rail top-clamping mounting system is designed with the professional PV solar installer in mind. The top-clamping rail utilizes a single tool with a revolutionary RAD™ Fastener for faster bolt placement. The unique shape of the RAD provides an anti-rotation feature, locking the bolt in the proper orientation when installed. The high

strength rigid rail also includes an integral wiring channel for securing cables and providing a professional finish. The system includes all of the mounting options from the Power Rail family, designed for secure and water tight attachments to any roof style.

Mounting Rail Options

P6 Engineered to save cost on shorter span applications

P8 Engineered for longer span and heavier snow conditions

* Reference Rail Span and Cantilever Charts on page 14.

Features

High Strength Reliable Design

- Engineered rail profiles for maximum strength-to-weight ratio
- Structural Aluminum rigid rail construction
- High Strength stainless steel module clamps and hardware

Reduced Installation Time and Costs

- Single Tool Assembly – all 5/16" hardware
- RAD Fastener for quick bolt placements anywhere along rail
- Under flange clamping option
- Tile Hooks
- Integral Wiring Channel for securing cables

- Standard lengths up to 27 feet eliminate costly rail splices
- Snap-In WEEB Integral module grounding option

Flexible Mounting Options

- Height adjustable "L" mounting feet
- Tilt Feet up to 10 degrees
- Solid Aluminum Power Post™ stanchions
- Easy Feet™ attachment anywhere on metal or composite roof decking
- PV Flashing hardware
- Telescoping and One-Piece Tilt Kits up to 65 degrees

Power Rail™ Extrusions

Power Rail is an engineered profile extrusion made from Series 6000 structural aluminum. Standard finish is mill-finish aluminum.



Power Rail P6– Extrusion

P6 Standard Lengths

| Part # | P6-84 | P6-126 | P6-162 | P6-204 | P6-240 | P6-282 | P6-324 |
|--|-------|--------|--------|--------|--------|--------|--------|
| Length | 84" | 126" | 162" | 204" | 240" | 282" | 324" |
| Weight Per Unit (lbs.) | 5 | 7.5 | 9.5 | 12 | 14 | 16.5 | 19 |
| Pricing per Quantities (Higher Volume Discount Available) | | | | | | | |
| 1-19 | 44.00 | 65.00 | 83.00 | 103.00 | 120.00 | 139.00 | 158.00 |
| 20-39 | 42.00 | 63.00 | 80.00 | 99.00 | 116.00 | 134.00 | 152.00 |
| 40-59 | 41.00 | 60.00 | 77.00 | 96.00 | 111.00 | 129.00 | 146.00 |
| 60-79 | 40.00 | 59.00 | 74.00 | 92.00 | 107.00 | 124.00 | 140.00 |
| 80-99 | 38.00 | 56.00 | 72.00 | 88.00 | 103.00 | 119.00 | 135.00 |
| 100+ | 36.00 | 54.00 | 68.00 | 85.00 | 98.00 | 114.00 | 129.00 |



Power Rail P8– Extrusion

P8 Standard Lengths

| Part # | P8-84 | P8-126 | P8-162 | P8-204 | P8-240 | P8-282 | P8-324 |
|--|-------|--------|--------|--------|--------|--------|--------|
| Length | 84" | 126" | 162" | 204" | 240" | 282" | 324" |
| Weight Per Unit (lbs.) | 7 | 10.5 | 13.5 | 17 | 20 | 23.5 | 27 |
| Pricing per Quantities (Higher Volume Discount Available) | | | | | | | |
| 1-19 | 68.00 | 100.00 | 128.00 | 159.00 | 184.00 | 214.00 | 243.00 |
| 20-39 | 65.00 | 97.00 | 123.00 | 153.00 | 178.00 | 206.00 | 234.00 |
| 40-59 | 63.00 | 93.00 | 119.00 | 147.00 | 171.00 | 198.00 | 225.00 |
| 60-79 | 61.00 | 90.00 | 114.00 | 142.00 | 164.00 | 191.00 | 216.00 |
| 80-99 | 58.00 | 86.00 | 110.00 | 136.00 | 158.00 | 183.00 | 207.00 |
| 100+ | 56.00 | 83.00 | 105.00 | 130.00 | 151.00 | 175.00 | 198.00 |

Power Rail™ Splice Plates

Splice Plates

| Part # | Description | Quantity | Weight Per Unit (lbs.) | Price |
|--------|---------------------|----------|------------------------|-------|
| P6-SPK | Splice Plate for P6 | 1-9 | 0.25 | 7.00 |
| | | 10+ | | 6.50 |
| P8-SPK | Splice Plate for P8 | 1-9 | 0.40 | 8.00 |
| | | 10+ | | 7.50 |



Tilted "L" Feet

| Part # | Description | Quantity | Weight Per Unit (lbs.) | Price |
|--------|----------------|----------|------------------------|-------|
| FF5 | 5° Front Foot | 1-49 | 0.25 | 8.00 |
| | | 50-99 | | 7.50 |
| | | 100+ | | 7.00 |
| BF5 | 5° Back Foot | 1-49 | 0.50 | 12.00 |
| | | 50-99 | | 11.50 |
| | | 100+ | | 11.00 |
| FF10 | 10° Front Foot | 1-49 | 0.25 | 8.00 |
| | | 50-99 | | 7.50 |
| | | 100+ | | 7.00 |
| BF10 | 10° Back Foot | 1-49 | 0.75 | 16.00 |
| | | 50-99 | | 15.50 |
| | | 100+ | | 15.00 |



Telescoping Tilt Kits

P6 Low-Profile Telescoping Tilt Kits

| Part # | Description | Quantity | Weight Per Unit (lbs.) | Price |
|---------|--|----------|------------------------|--------|
| P6-TL35 | Telescoping legs that range from 20°–35° | 1-49 | 9.0 | 135.00 |
| | | 50-99 | | 130.00 |
| | | 100+ | | 125.00 |
| P6-TL45 | Telescoping legs that range from 24°–45° | 1-49 | 11.0 | 140.00 |
| | | 50-99 | | 135.00 |
| | | 100+ | | 130.00 |
| P6-TL55 | Telescoping legs that range from 28°–55° | 1-49 | 13.0 | 145.00 |
| | | 50-99 | | 140.00 |
| | | 100+ | | 135.00 |
| P6-TL65 | Telescoping legs that range from 30°–65° | 1-49 | 15.0 | 150.00 |
| | | 50-99 | | 145.00 |
| | | 100+ | | 140.00 |



P6 Low-Profile Telescoping Tilt Kit

P8 Low-Profile Telescoping Tilt Kits

| Part # | Description | Quantity | Weight Per Unit (lbs.) | Price |
|---------|--|----------|------------------------|--------|
| P8-TL35 | Telescoping legs that range from 20°–35° | 1-49 | 10.0 | 155.00 |
| | | 50-99 | | 150.00 |
| | | 100+ | | 145.00 |
| P8-TL45 | Telescoping legs that range from 24°–45° | 1-49 | 12.0 | 160.00 |
| | | 50-99 | | 155.00 |
| | | 100+ | | 150.00 |
| P8-TL55 | Telescoping legs that range from 28°–55° | 1-49 | 14.0 | 165.00 |
| | | 50-99 | | 160.00 |
| | | 100+ | | 155.00 |
| P8-TL65 | Telescoping legs that range from 30°–65° | 1-49 | 16.0 | 170.00 |
| | | 50-99 | | 165.00 |
| | | 100+ | | 160.00 |



P8 Low-Profile Telescoping Tilt Kit

Note: Telescoping Tilt Kits include 3.5" L-feet, Strongback, Telescoping leg, and Rail-to-Rail brackets.

One-Piece Tilt Kits

P6 Low-Profile One-Piece Tilt Kits

| Part # | Description | Quantity | Weight Per Unit (lbs.) | Price |
|---------|-------------------------------|----------|------------------------|--------|
| P6-OP15 | One-Piece legs for a 15° tilt | 1-49 | 6.5 | 85.00 |
| | | 50-99 | | 81.50 |
| | | 100+ | | 78.00 |
| P6-OP25 | One-Piece legs for a 25° tilt | 1-49 | 7.0 | 90.00 |
| | | 50-99 | | 86.50 |
| | | 100+ | | 83.00 |
| P6-OP35 | One-Piece legs for a 35° tilt | 1-49 | 7.5 | 95.00 |
| | | 50-99 | | 91.50 |
| | | 100+ | | 88.00 |
| P6-OP45 | One-Piece legs for a 45° tilt | 1-49 | 8.0 | 100.00 |
| | | 50-99 | | 96.50 |
| | | 100+ | | 93.00 |
| P6-OP55 | One-Piece legs for a 55° tilt | 1-49 | 8.5 | 105.00 |
| | | 50-99 | | 101.50 |
| | | 100+ | | 98.00 |
| P6-OP65 | One-Piece legs for a 65° tilt | 1-49 | 9.0 | 110.00 |
| | | 50-99 | | 106.50 |
| | | 100+ | | 103.00 |



P6 Low-Profile One-Piece Tilt Kit

P8 Low-Profile One-Piece Tilt Kits

| Part # | Description | Quantity | Weight Per Unit (lbs.) | Price |
|---------|-------------------------------|----------|------------------------|--------|
| P8-OP15 | One-Piece legs for a 15° tilt | 1-49 | 7.5 | 105.00 |
| | | 50-99 | | 101.50 |
| | | 100+ | | 98.00 |
| P8-OP25 | One-Piece legs for a 25° tilt | 1-49 | 8.0 | 110.00 |
| | | 50-99 | | 106.50 |
| | | 100+ | | 103.00 |
| P8-OP35 | One-Piece legs for a 35° tilt | 1-49 | 8.5 | 115.00 |
| | | 50-99 | | 111.50 |
| | | 100+ | | 108.00 |
| P8-OP45 | One-Piece legs for a 45° tilt | 1-49 | 9.0 | 120.00 |
| | | 50-99 | | 116.50 |
| | | 100+ | | 113.00 |
| P8-OP55 | One-Piece legs for a 55° tilt | 1-49 | 9.5 | 125.00 |
| | | 50-99 | | 121.50 |
| | | 100+ | | 118.00 |
| P8-OP65 | One-Piece legs for a 65° tilt | 1-49 | 10.0 | 130.00 |
| | | 50-99 | | 126.50 |
| | | 100+ | | 123.00 |



P8 Low-Profile One-Piece Tilt Kit

Note: One-Piece Tilt Kits include 3.5" L-feet, Strongback, One-Piece leg, and Rail-to-Rail brackets.

(800) 260.3792

Module Clamps

Module Clamps are Type 304 stainless steel for higher yield strength and durability. The low profile design and slim 3/8" gap between modules provide a professional appearance and higher module density.

RAD™ Hardware

| Part # | Description | Quantity | Weight Per Unit (lbs.) | Price |
|-------------------------------|---------------------------------|----------|------------------------|-------|
| EC- <input type="text"/> -RAD | Module End Clamp w/RAD Hardware | 1-19 | 0.15 | 6.50 |
| | | 20-39 | | 6.05 |
| | | 40-59 | | 5.85 |
| | | 60-79 | | 5.65 |
| | | 80-99 | | 5.45 |
| | | 100+ | | 5.25 |
| MC- <input type="text"/> -RAD | Module Mid Clamp w/RAD Hardware | 1-49 | 0.08 | 5.75 |
| | | 50-99 | | 5.00 |
| | | 100+ | | 4.50 |



Mid Clamp w/RAD Bolt



End Clamp w/RAD Bolt

Note: Replace with module depth from the Solar Module Depth Reference Chart at www.power-fab.com.

Example: EC-46-RAD end clamp or MC-46-RAD mid clamp for Sharp NU-U240F1 modules
Add "B" suffix to part number for black powder coat. Example: EC-46-RAD-B. (Add 25% to price)

Carriage Bolt Hardware

| Part # | Description | Quantity | Weight Per Unit (lbs.) | Price |
|-------------------------------|---|----------|------------------------|-------|
| EC- <input type="text"/> -CAR | Module End Clamp w/Carriage Bolt Hardware | 1-19 | 0.15 | 5.25 |
| | | 20-39 | | 5.05 |
| | | 40-59 | | 4.85 |
| | | 60-79 | | 4.65 |
| | | 80-99 | | 4.45 |
| | | 100+ | | 4.25 |
| MC- <input type="text"/> -CAR | Module Mid Clamp w/Carriage Bolt Hardware | 1-49 | 0.08 | 4.50 |
| | | 50-99 | | 3.75 |
| | | 100+ | | 3.25 |



End Clamp w/Carriage Bolt



Mid Clamp w/Carriage Bolt

Note: Replace with module depth from the Solar Module Depth Reference Chart at www.power-fab.com.

Example: EC-46-CAR end clamp or MC-46-CAR mid clamp for Sharp NU-U240F1
Add "B" suffix to part number for black powder coat. Example: EC-46-RAD-B. (Add 25% to price)

Universal End Clamp

| Part # | Description | Quantity | Weight Per Unit (lbs.) | Price |
|--------|---------------------------------------|----------|------------------------|-------|
| P6-ECU | Universal End Clamp w/Set Bolt for P6 | 1-49 | 0.15 | 9.00 |
| | | 50-99 | | 8.50 |
| | | 100+ | | 8.00 |
| P8-ECU | Universal End Clamp w/Set Bolt for P8 | 1-49 | 0.25 | 10.00 |
| | | 50-99 | | 9.50 |
| | | 100+ | | 9.00 |

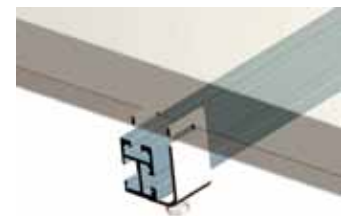

“L” Feet

“L” Feet are fabricated from high strength 3/16" aluminum and include a vertical slot for adjusting to irregular surfaces.

| Part # | Description | Quantity | Weight Per Unit (lbs.) | Price |
|--------|---------------------------|----------|------------------------|-------|
| LF2 | 2.5" Tall L-Mounting Foot | 1-49 | 0.20 | 7.00 |
| | | 50-99 | | 6.50 |
| | | 100+ | | 6.00 |
| LF3 | 3.5" Tall L-Mounting Foot | 1-49 | 0.24 | 9.00 |
| | | 50-99 | | 8.50 |
| | | 100+ | | 7.00 |
| LF5 | 5" Tall L-Mounting Foot | 1-49 | 0.40 | 10.00 |
| | | 50-99 | | 9.25 |
| | | 100+ | | 8.50 |
| LF6 | 6" Tall L-Mounting Foot | 1-49 | 0.45 | 12.00 |
| | | 50-99 | | 11.00 |
| | | 100+ | | 9.75 |
| PPB | Power Post Bracket | 1-49 | .09 | 6.50 |
| | | 50-99 | | 6.00 |
| | | 100+ | | 5.50 |



Easy Feet™

Easy Feet mount directly to metal and composite shingles or other roofing materials and do not require attachment to a roof structural member. Sealing butyl mastic backing and RSS PHEinox™ screws are included.

| Part # | Description | Quantity | Weight Per Unit (lbs.) | Price |
|--------|--------------------------|----------|------------------------|-------|
| PEF | Pivot Easy Mounting Foot | 1-49 | 0.76 | 21.50 |
| | | 50-99 | | 20.50 |
| | | 100+ | | 19.00 |



RSS PHEinox™ screws are manufactured by GRK Fasteners.

(800) 260.3792

Corrugated Roof Mounts

| Part # | Description | Quantity | Price |
|--------|---|----------|-------|
| CMB | Mounting Bridge to Span Peaks of Corrugated Metal Roofs | 1-49 | 13.50 |
| | | 50-99 | 12.50 |
| | | 100+ | 11.00 |

Note: Not all corrugated metal roofs are the same. Please contact DPW Solar to design mounting bridges that are specific to your application. Pricing subject to change. L-Foot not included.

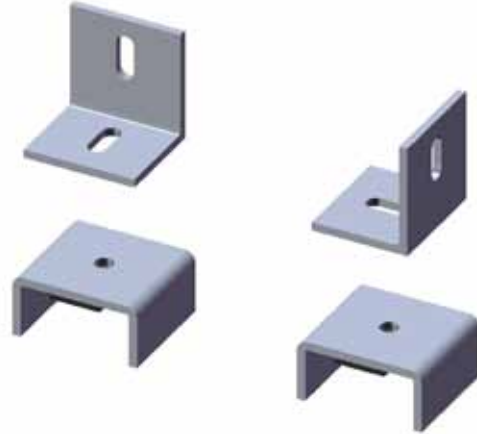

Roof Rod Mount

Roof Rod mounts attach directly to the roof deck and are suitable for tile and other roofing materials. Simply, drill a hole through the roofing material. Sealing butyl mastic backing and RSS PHEinox™ screws included.

| Part # | Description | Quantity | Weight Per Unit (lbs.) | Price |
|--------|--------------------|----------|------------------------|-------|
| RRM | Threaded Rod Mount | 1-49 | 1.5 | 30.00 |
| | | 50-99 | | 29.00 |
| | | 100+ | | 27.50 |

Note: L Foot included.



RSS PHEinox™ screws are manufactured by GRK Fasteners.

(800) 260.3792



www.DPWSolar.com

Power Post™ Stanchions

Power posts offer high strength solid aluminum construction and are used with flashing cones.

| Part # | Description | Diameter | Quantity | Weight Per Unit (lbs.) | Price |
|--------|---------------|----------|----------|------------------------|-------|
| PP3 | 3" Power Post | 1.31" | 1-49 | 0.55 | 20.50 |
| | | | 50-99 | | 19.50 |
| | | | 100+ | | 18.00 |
| PP4 | 4" Power Post | 1.31" | 1-49 | 0.67 | 21.00 |
| | | | 50-99 | | 20.00 |
| | | | 100+ | | 18.50 |
| PP5 | 5" Power Post | 1.31" | 1-49 | 0.81 | 21.50 |
| | | | 50-99 | | 20.50 |
| | | | 100+ | | 19.00 |
| PP6 | 6" Power Post | 1.31" | 1-49 | 0.94 | 22.00 |
| | | | 50-99 | | 21.00 |
| | | | 100+ | | 19.50 |
| PP7 | 7" Power Post | 1.31" | 1-49 | 1.1 | 22.50 |
| | | | 50-99 | | 21.50 |
| | | | 100+ | | 20.00 |

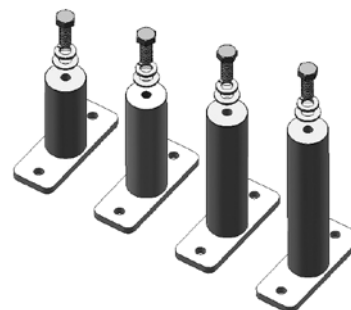

Super Post™ Stanchions

Super posts offer high strength solid aluminum construction for larger arrays and higher roof clearance.

| Part # | Description | Diameter | Quantity | Weight Per Unit (lbs.) | Price |
|--------|-------------------------|----------|----------|------------------------|-------|
| SP7 | 7" Super Mounting Post | 1.75" | 1-49 | 2.4 | 40.50 |
| | | | 50-99 | | 37.50 |
| | | | 100+ | | 34.50 |
| SP8 | 8" Super Mounting Post | 1.75" | 1-49 | 2.6 | 42.00 |
| | | | 50-99 | | 39.00 |
| | | | 100+ | | 36.00 |
| SP9 | 9" Super Mounting Post | 1.75" | 1-49 | 2.9 | 43.50 |
| | | | 50-99 | | 40.50 |
| | | | 100+ | | 37.50 |
| SP10 | 10" Super Mounting Post | 1.75" | 1-49 | 3.2 | 45.00 |
| | | | 50-99 | | 42.00 |
| | | | 100+ | | 39.00 |

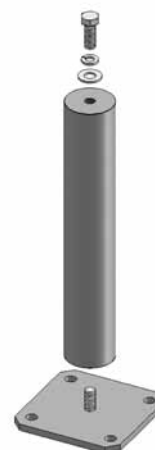

Easy Power Post™ Stanchions

| Part # | Description | Diameter | Quantity | Weight Per Unit (lbs.) | Price |
|--------|--------------|----------|----------|------------------------|-------|
| EP3 | 3" Easy Post | 1.31" | 1-49 | 0.82 | 25.00 |
| | | | 50-99 | | 24.00 |
| | | | 100+ | | 22.50 |
| EP4 | 4" Easy Post | 1.31" | 1-49 | 0.94 | 25.50 |
| | | | 50-99 | | 24.50 |
| | | | 100+ | | 23.00 |
| EP5 | 5" Easy Post | 1.31" | 1-49 | 1.08 | 26.00 |
| | | | 50-99 | | 25.00 |
| | | | 100+ | | 23.50 |
| EP6 | 6" Easy Post | 1.31" | 1-49 | 1.21 | 26.50 |
| | | | 50-99 | | 25.50 |
| | | | 100+ | | 24.00 |
| EP7 | 7" Easy Post | 1.31" | 1-49 | 1.37 | 27.00 |
| | | | 50-99 | | 26.00 |
| | | | 100+ | | 24.50 |

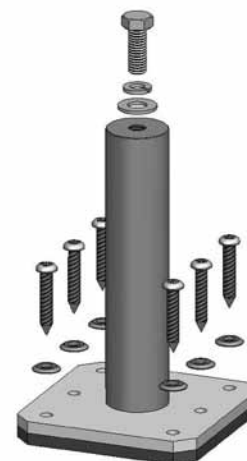

RSS PHEinox™ screws are manufactured by GRK Fasteners.

Offset Power Post™ Stanchions

Offset Power Posts center the flashing cone and avoid potential gaps with the Power Post base.

| Part # | Description | Diameter | Quantity | Weight Per Unit (lbs.) | Price |
|--------|-------------------------|----------|----------|------------------------|-------|
| OP3 | 3" Offset Mounting Post | 1.31" | 1-49 | 0.55 | 20.50 |
| | | | 50-99 | | 19.50 |
| | | | 100+ | | 18.00 |
| OP4 | 4" Offset Mounting Post | 1.31" | 1-49 | 0.67 | 21.00 |
| | | | 50-99 | | 20.00 |
| | | | 100+ | | 18.50 |
| OP5 | 5" Offset Mounting Post | 1.31" | 1-49 | 0.81 | 21.50 |
| | | | 50-99 | | 20.50 |
| | | | 100+ | | 19.00 |
| OP6 | 6" Offset Mounting Post | 1.31" | 1-49 | 0.94 | 22.00 |
| | | | 50-99 | | 21.00 |
| | | | 100+ | | 19.50 |
| OP7 | 7" Offset Mounting Post | 1.31" | 1-49 | 1.1 | 22.50 |
| | | | 50-99 | | 21.50 |
| | | | 100+ | | 20.00 |

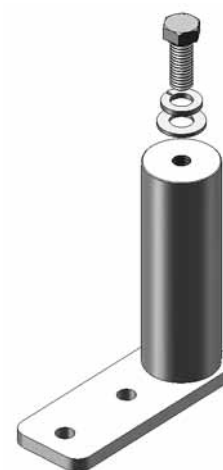

(800) 260.3792

POWER-FAB®

www.DPWSolar.com

Power Rail™ Accessories

Power Rail™ PV Flash

Power Rail PV Flash includes one universal slotted compression block, and one 8" x 12" flashing in matte, black color.

| Part # | Attachment Hardware | Qty. | Shipping Weight Per Unit (lbs.) | Price |
|--------|---|-------|---------------------------------|-------|
| PFU* | 5/16" x 5" hangerbolt | 10-49 | 0.80 | 14.00 |
| | | 50-99 | | 13.00 |
| | | 100+ | | 11.50 |
| PVU* | Stainless Steel Base Plate and 3" Fasteners | 1-49 | 1.00 | 16.00 |
| | | 50-99 | | 15.00 |
| | | 100+ | | 13.50 |

*MUST order in quantities of 10

Power Rail accessories are non-discountable products

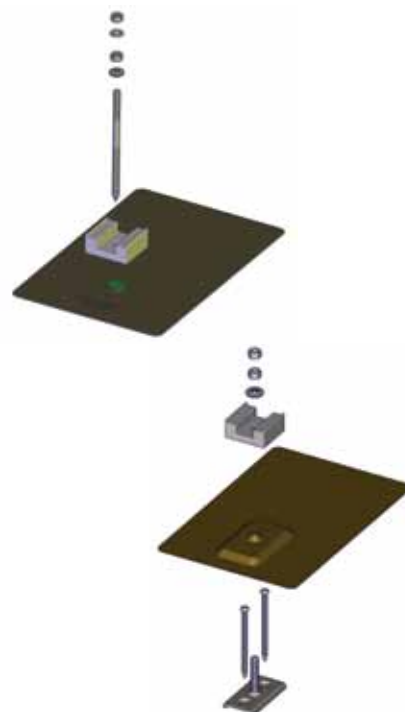

Power Post Flashing

| Part # | Attachment Hardware | Qty. | Weight Per Unit (lbs.) | Price |
|--------|---|-------|------------------------|-------|
| OF* | Oatey Flashing with Rubber Boot for 1.31" posts | 12-47 | 0.66 | 5.15 |
| | | 48-95 | | 4.40 |
| | | 96+ | | 3.90 |
| SMF* | Aluminum One Piece Flashing | 12-47 | 1.15 | 10.40 |
| | | 48-95 | | 8.90 |
| | | 96+ | | 7.85 |
| RFC* | Rubber Flashing Collar | 12-47 | 0.05 | 2.00 |
| | | 48-95 | | 1.75 |
| | | 96+ | | 1.55 |

NOTE: Oatey No-Calk® NC-1 Solar flashing are galvanized with a UV Rubber Boot that fits onto the Power Post. Oatey flashing may be used on roofs with 0-45 degree angles.

*MUST order in quantities of 12

Power Rail accessories are non-discountable products

No-Calk® is a registered trademark of Oatey Co.

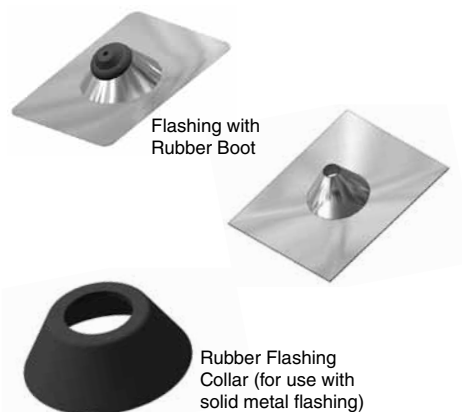

Power Rail™ Accessories

Flat Roof Flashing

| Part # | Description | Quantity | Weight Per Unit (lbs.) | Price |
|--------|----------------------------------|----------|------------------------|--------|
| LPK4* | 4" Lockin' Pocket | 6-47 | 1.7 | 15.50 |
| | | 48-95 | | 14.50 |
| | | 96+ | | 13.50 |
| LPK6** | 6" Lockin' Pocket | 4-47 | 2.6 | 23.00 |
| | | 48-95 | | 21.50 |
| | | 96+ | | 20.50 |
| HFUS | Hurricane Force Universal Sealer | 1 | - | 27.75 |
| BPAG | Battery Powered Applicator Gun | 1 | - | 690.00 |

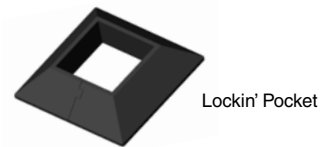

Lockin' Pocket

NOTE: Lockin' Pockets and Hurricane Force Sealer are backed by a third party warranty on all flat roof penetrations.

*MUST order in quantities of 6

**MUST order in quantities of 4

Power Rail accessories are non-discountable products

Grounding Hardware

| Part # | Description | Quantity | Weight Per Unit (lbs.) | Price |
|---------------|-----------------------------|----------|------------------------|-------|
| WEEB-DPF* | Module Grounding Clip | 10-99 | .003 | 1.50 |
| | | 100-999 | | 1.10 |
| | | 1000+ | | .90 |
| WEEB-11.5* | Splice Plate Grounding Clip | 10-99 | .003 | 1.50 |
| | | 100-999 | | 1.10 |
| | | 1000+ | | .90 |
| WEEBL-8.0* | Rail Grounding Lug | 10-99 | 0.19 | 5.65 |
| | | 100+ | | 4.65 |
| WEEB-8.0-RBJ* | Rail Bonding Jumper | 10-99 | 0.11 | 7.80 |
| | | 100+ | | 6.45 |
| ACC-PV* | ACME PV Cable Clip | 10-99 | 0.006 | .52 |
| | | 100-999 | | .41 |
| | | 1000+ | | .33 |
| ACC* | ACME – 2 Cable Clip | 10-99 | 0.006 | .52 |
| | | 100-999 | | .41 |
| | | 1000+ | | .33 |



WEEB-DPF Module Grounding Clip



WEEB 11.5



WEEB Rail Grounding Lug

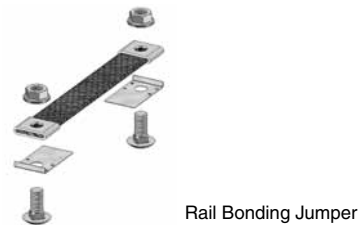

Rail Bonding Jumper



ACME Cable Clip

NOTE: Cable Clips snugly hold 1 or 2 designated cables.

*MUST order in quantities of 10

Power Rail accessories are non-discountable products

Rail Span and Cantilever Distances

P6 Rail Span and Cantilever Distances (inches)

| | SPAN/C'VER | SNOW LOAD (PSF) | | | | | | | | | | |
|----------------------|------------|-----------------|-------|-------|-------|-------|-------|-------|-------|-------|-------|-------|
| | | 0 | 10 | 20 | 30 | 40 | 50 | 60 | 70 | 80 | 90 | 100 |
| WIND SPEED (MPH)* | 90 | 72/36 | 60/32 | 54/26 | 48/24 | 43/21 | 40/20 | 36/18 | 33/16 | 31/15 | 29/14 | 28/14 |
| | 100 | 60/32 | 58/28 | 48/24 | 46/23 | 42/21 | 38/19 | 36/18 | 33/16 | 31/15 | 29/14 | 28/14 |
| | 110 | 58/28 | 54/26 | 48/24 | 44/22 | 40/20 | 37/18 | 35/17 | 33/16 | 31/15 | 29/14 | 28/14 |
| | 120 | 54/26 | 54/26 | 46/23 | 42/21 | 39/19 | 36/18 | 34/17 | 32/16 | 31/15 | 29/14 | 28/14 |
| | 130 | 48/24 | 48/24 | 44/22 | 40/20 | 37/18 | 35/17 | 33/16 | 32/16 | 30/15 | 29/14 | 28/14 |

* Exposure C Category Only

Please refer to design guidelines and ASCE requirements for more information.

P8 Rail Span and Cantilever Distances (inches)

| | SPAN/C'VER | SNOW LOAD (PSF) | | | | | | | | | | |
|----------------------|------------|-----------------|-------|-------|-------|-------|-------|-------|-------|-------|-------|-------|
| | | 0 | 10 | 20 | 30 | 40 | 50 | 60 | 70 | 80 | 90 | 100 |
| WIND SPEED (MPH)* | 90 | 96/48 | 92/46 | 80/40 | 72/36 | 66/33 | 62/31 | 58/29 | 52/26 | 50/25 | 46/23 | 44/22 |
| | 100 | 88/44 | 86/43 | 76/38 | 68/34 | 64/32 | 60/30 | 56/28 | 52/26 | 50/25 | 46/23 | 44/22 |
| | 110 | 80/40 | 80/40 | 72/36 | 66/33 | 62/31 | 58/29 | 54/27 | 52/26 | 50/25 | 46/23 | 44/22 |
| | 120 | 74/37 | 74/37 | 68/34 | 64/32 | 60/30 | 56/28 | 52/26 | 50/25 | 48/24 | 46/23 | 44/22 |
| | 130 | 68/34 | 68/34 | 66/33 | 60/30 | 56/28 | 54/27 | 52/26 | 48/24 | 46/23 | 44/22 | 44/22 |
| | 140 | 64/32 | 64/32 | 62/31 | 58/29 | 54/27 | 52/26 | 50/25 | 48/24 | 46/23 | 44/22 | 42/21 |
| | 150 | 60/30 | 60/30 | 60/30 | 56/28 | 52/26 | 50/25 | 48/24 | 46/23 | 44/22 | 42/21 | 42/21 |

* Exposure C Category Only

Please refer to design guidelines and ASCE requirements for more information.



Direct Power & Water Corporation
4000-B Vassar Drive NE
Albuquerque, New Mexico 87107 USA

Telephone: 505.889.3585
Toll Free: (800) 260.3792
Fax: 505.889.3548
Web site: www.DPWSolar.com
Email: info@power-fab.com

© 2011 Preformed Line Products
Printed in U.S.A.
SL-ML-1034-2P
01.11.00